

COVID19 IgG & IgM Antibody Detection Kit (Colloidal Gold Method) For in vitro diagnosis

Catalog : (1 Test)

● KIT COMPONENTS

Component	Specification
Detection Cassette	1 unit / bag (2 test cassettes)
Dropper	1 pcs
Sample Diluent	300 µl / tube
Lancet	1 pcs
Alcohol cotton	1 pcs
Product Manual	1 pcs

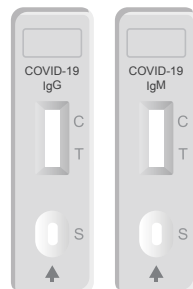

C : Quality control line
T : Test line
S : Specimen well

● STORAGE AND EXPIRATION

Keep kit in a cool and dry place at 2-30°C. Do not freeze the individual kit and / or box. Correctly stored kit are valid for 18 months (see the kit box for expiration information).

● SPECIMEN COLLECTION AND PREPARATION

- Sample should be human serum, plasma, fingertip blood and whole blood, other body fluid and samples may cause incorrect or inaccurate results.
- Venous blood should be collected under sterile condition at any time of a day.
- Suggest using serum or plasma for better results.
- Heparin, sodium citrate and EDTA can be used as anticoagulant for plasma, fingertip blood and whole blood sample.
- Sample Volume : 10 µL of serum and plasma sample, 40 µL of fingertip blood and whole blood sample.

● INTERPRETATION OF TEST RESULTS

- Positive for COVID-19: The quality control line (C) is colored dark pink, and the test line (T) is colored dark pink or light pink.
- Negative for COVID-19: The test line (T) does not develop color, but the quality control line (C) is colored.
- Invalid: There is no colored control line (C) band. The results are invalid regardless of whether a red band appears on the test line (T); additional testing is required.

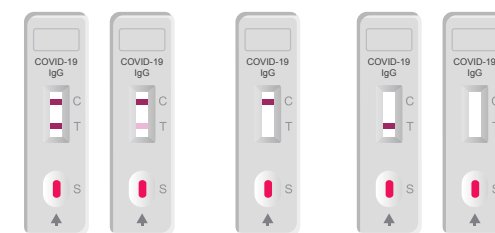

Positive

Negative

Invalid

Representative schematic of possible lateral flow device results

● TEST PROCEDURE

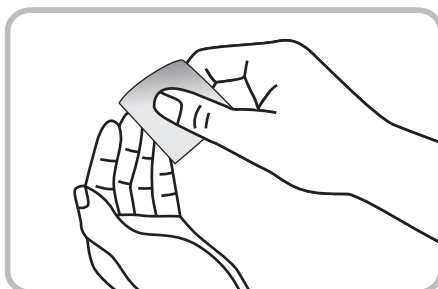

1. Cleaning the finger with an alcohol swab.

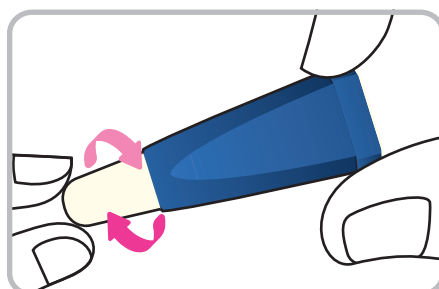

2. Twist the cap off the lancet.

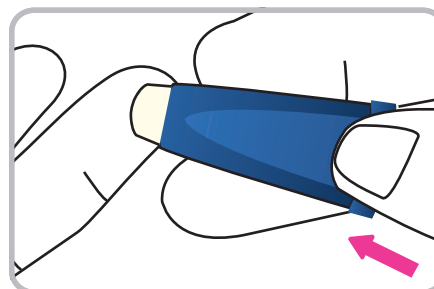

3. Press lancet firmly against the collection site to puncture the finger.

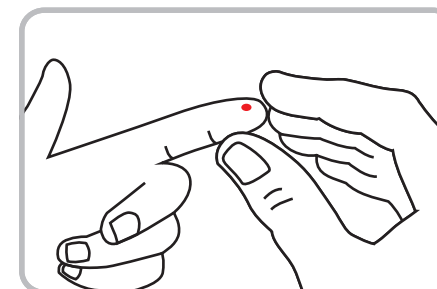

4. Press the blood collection site with thumb to collect enough blood sample.

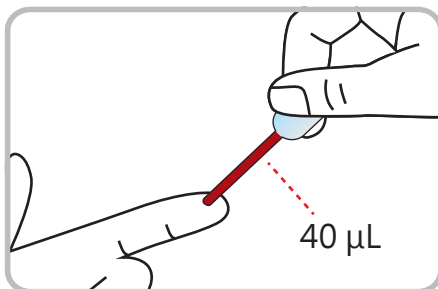

5. Collection the blood sample with plastic pipette dropper

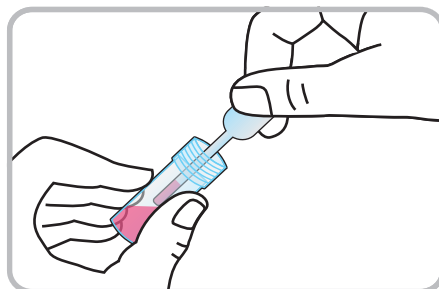

6. Draw blood into the sample diluent vial and mix with dropper gently.

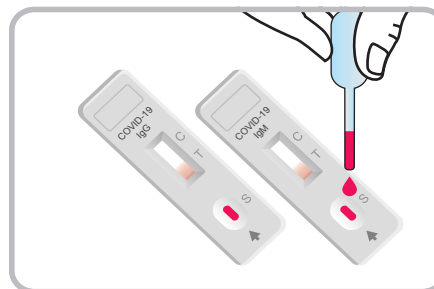

7. Add 2 drops of the premixed blood sample to the specimen well of the test device. Take care to avoid bubbles.

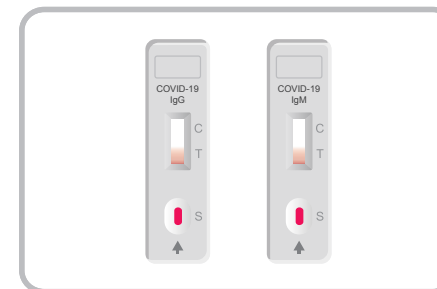

8. Read test result at 5-8 minutes. Results measured after 20 minutes are invalid and should be discarded.

Index of Symbols

	Consult instructions for use
	For in vitro diagnostic use only
	Store between 2-30°C
	Test per kit
	Use by
	Lot Number
	Authorized Representative
	Do not reuse
	Catalogue number



EC REP

CTP16 1PW, UK